

FEATURES FOR THE SHERPA CLT CONNECTOR



The SHERPA CLT connector is a coupling element for angle joints, t-joints and longitudinal joints, wall to ceiling connections, as well as ceiling joints.

Optimised for three-layer and five-layer cross-laminated timber elements, the SHERPA CLT connector can be mounted flush in solid wood or glulam already in the preinstallation phase, enabling ready-for-installation delivery to the construction site.

The CLT connector must be milled flush into cross laminated timber or glulam. The load capacity according to ETA can only be guaranteed when using SHERPA special screws.

GEOMETRY

CLT connector	
Dimensions	18 x 40 x 110 mm
Connecting material	8 pcs. 8,0 x 100 / 120 / 140 mm 2 pcs. 6,5 x 65 mm

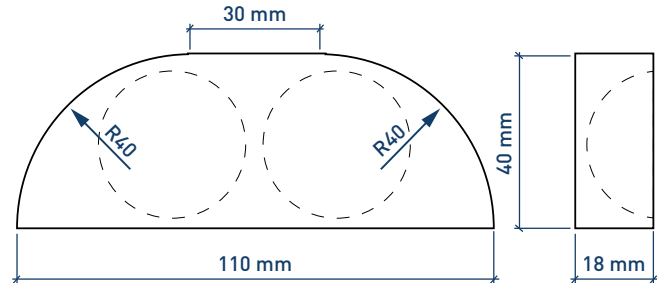

TECHNICAL DATA

Configuration			Characteristic value ¹⁾		
			Interlayer ≤ 12 mm	Compriband ≤ 2 mm	
Normal forces	Carrying capability	$R_{1,k}$	18,80 ²⁾		kN
	Stiffness	K_{ser}	9.750		N/mm
Shear force on the surface	Carrying capability	$R_{2,k}$	10,00 ²⁾		kN
	Stiffness	K_{ser}	3.300		N/mm
Shear force from the surface (positive)	Carrying capability	$R_{3,k}(+)$	16,00 ²⁾	16,50 ²⁾	kN
	Stiffness	K_{ser}	3.600		N/mm
Shear force from the surface (negative)	Carrying capability	$R_{3,k}(-)$	5,30	7,00	kN
	Stiffness	K_{ser}	870	1.000	N/mm

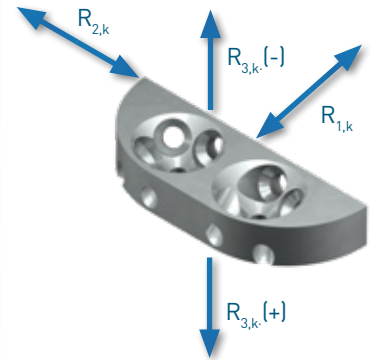

¹⁾ ETA 18/0083

²⁾ screw l = 120 mm: ns = 1,22

screw l = 140 mm: ns = 1,44

$R'_k = n_s \cdot R_k$

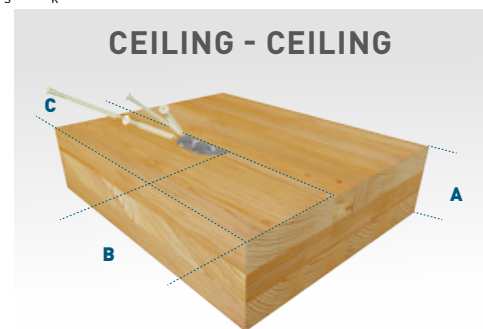
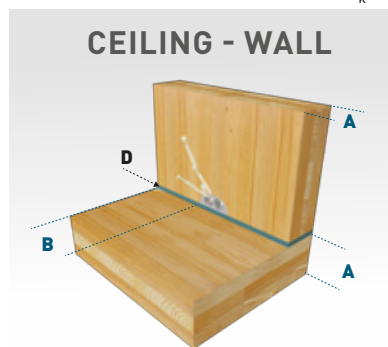
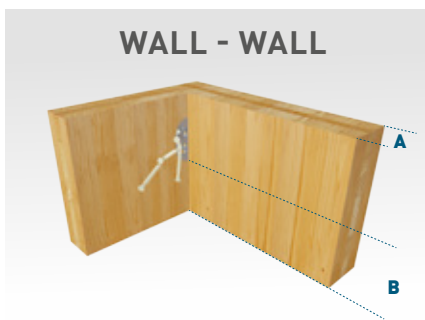

A material thickness: 80 bis 160 mm; > 120 mm: flush milling or install both-sided

B edge distance: min. 250 mm

C min. 100 mm

D Interlayer (e.g. Regufoam): max. 12 mm | Compression hardness: min. 0,2 N/mm² | Static elasticity modulus: min. 1,0 N/mm²

INSTALLATION INSTRUCTIONS

- Milling: 18 mm into solid wood or glulam
- Max. distance between the CLT connectors: $e_{max} = 2$ m
- 2 pcs. special screws 6.5 x 65
- 4 pcs. special screws 8.0 x 100 / 120 / 140 (fix to solid wood / glulam)
- 4 pcs. special screws 8.0 x 100 / 120 / 140 (mount on the second element)

SHERPA Connection Systems GmbH

Badl 31 | A- 8130 Frohnleiten

office@sherpa-connector.com | www.sherpa-connector.com

